

**vtech**<sup>®</sup>

User's Manual

## Explore & Learn Choo Choo™



© 2005 VTech  
Printed in China  
91-02142-000 (美)



**Dear Parent:**

*Ever notice the look on your baby's face when they learn something new through their own discovery? These self-accomplished moments are a parent's greatest reward. To help fulfill them, VTech® created the **Infant Learning**, series of toys.*

*These unique interactive learning toys directly respond to what children do naturally – play! Using innovative technology, these toys react to baby's interactions, making each play experience fun and unique as they learn age-appropriate concepts like first words, numbers, shapes, colors and music. More importantly, VTech®'s **Infant Learning** toys develop baby's mental and physical abilities by inspiring, engaging and teaching.*

*At VTech®, we know that a child has the ability to do great things. That's why all of our electronic learning products are uniquely designed to develop a child's mind and allow them to learn to the best of their ability. We thank you for trusting VTech® with the important job of helping your child learn and grow!*

*Sincerely,*

*Your Friends at VTech®*

*To learn more about **Infant Learning** and other VTech® toys, visit [www.vtech.com](http://www.vtech.com)*



## INTRODUCTION

Thank you for purchasing the **VTech® Explore & Learn Choo Choo™** learning toy!

The **VTech® Explore & Learn Choo Choo™** is an electronic toy for toddlers 9 months and up. The engine is fully equipped with a removable telephone, four number and shape buttons and a light-up bell, encouraging interaction and imaginative play. The middle car promotes gross motor movement with two brightly colored battable animals. The caboose offers a fun, musical play experience where toddlers can tap a tune on their piano. Don't forget to say hello to the friendly engineer as he sings his train song and rides along in the engine. All aboard for a fun learning adventure!

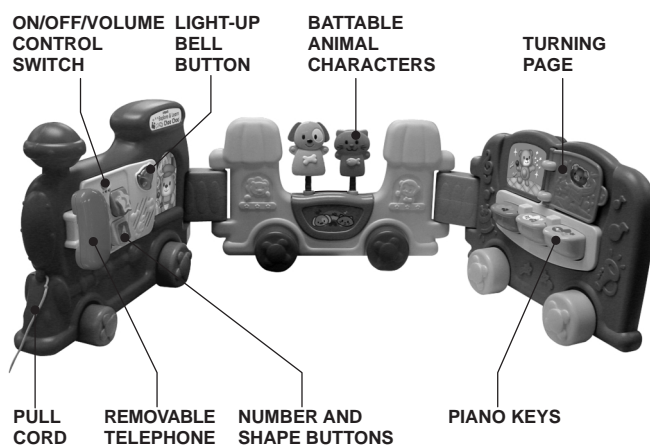

## INCLUDED IN THIS PACKAGE

- One VTech® Explore & Learn Choo Choo™
- 6 sets of wheels, two blue, two red and two yellow
- One instruction manual

**WARNING:** All packing materials, such as tape, plastic sheets, wire ties and tags are not part of this toy, and should be discarded for your child's safety.

## GETTING STARTED

### BATTERY INSTALLATION

1. Make sure the unit is turned **OFF**.
2. Locate the battery cover on the back of the middle train car. Use a coin or screwdriver to loosen the screw.
3. Install 2 new "AA" size (UM3/LR6) batteries following the diagram inside the battery box. (The use of new alkaline batteries is recommended for maximum performance.)
4. Replace the battery cover and tighten the screw to secure the battery cover.

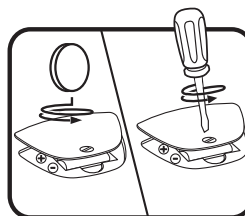



## BATTERY NOTICE

- Install batteries correctly observing the polarity (+, -) signs to avoid leakage.
- Do not mix old and new batteries.
- Do not use batteries of different types.
- Remove batteries from the equipment when the unit will not be used for an extended period of time.
- Do not dispose of batteries in fire.
- Do not attempt to recharge ordinary batteries.
- The supply terminals are not to be short-circuited.
- Only batteries of the same or equivalent type as recommended are to be used.
- Do not mix alkaline, standard (carbon-zinc) or rechargeable (nickel-cadmium) batteries.

**WE DO NOT RECOMMEND THE USE OF RECHARGEABLE BATTERIES.**

## PRODUCT FEATURES

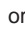
### 1. ON/OFF/VOLUME CONTROL SWITCH

To turn the unit **ON**, slide the **ON/OFF/VOLUME CONTROL SWITCH** to the **LOW VOLUME** (  ), or the **HIGH VOLUME** (  ) position. To turn the unit **OFF**, slide the **ON/OFF/VOLUME CONTROL SWITCH** to the **OFF** (  ) position.

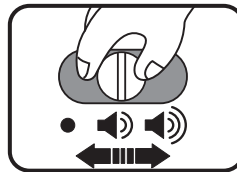

## 2. AUTOMATIC SHUT-OFF

To preserve battery life, the **VTech® Explore & Learn Choo Choo™** learning toy will automatically power-down after approximately 35 seconds without input. The unit can be turned on again by pressing any button.

## ASSEMBLY INSTRUCTIONS

To ensure your child's safety, the assembly of this product is an adult's activity not a child's activity. Please ensure the wheels are securely locked into position to avoid injury and ensure smooth rolling.

1. Remove the wheels from the packaging.
2. The blue wheels are intended for the first car, the red wheels for the second car and the yellow wheels for the third car. Place the wheels below the recessed wheel area on the train. Press down on the train to snap the wheels into place. Make sure the wheels are securely locked into position before use.
3. For long-term storage, remove the wheels and fold the train body. Store out of reach of children to prevent injury.

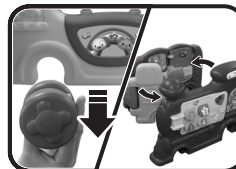
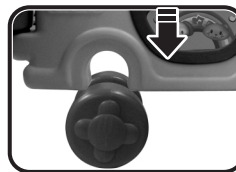

## ACTIVITIES

1. Slide the **on/off/volume control switch** to turn the unit on. You will hear train sounds followed by a song and an introductory phrase. The bell light will flash with the sound.

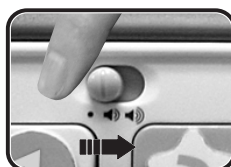

2. Press the **number buttons** while the phone is on the hook to hear numbers, counting sounds, colors, shapes and shape characteristics. Press the number buttons while the phone is off the hook to hear fun role-play phrases. The bell light will flash with the sound.



3. Press the **light-up bell button** to hear a song and a variety fun train phrases or sounds. The bell light will flash with the sound.



4. Press the two **battable animal characters** to hear the animals and their sounds introduced, as well as melodies with the corresponding animal sound singing with the melody. The bell light will flash with the sound.

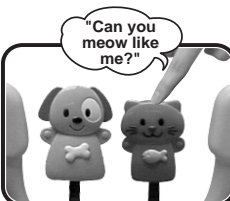

5. Turn the **turning page** on the caboose to change the response of the piano keys. Turn the page to the left to hear a twinkling sound, phrase and short tune. The piano keys now will play individual piano notes. Turn the page to the right to hear a twinkling sound, a fun phrase followed by a melody or a song. The piano keys will play a variety of melodies one note at a time. Press the piano keys to play a melody. The bell light will flash with the sound.

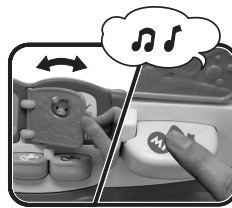

6. Pull the cord to roll the train and hear a variety of train sounds, phrases and a variety of melodies. The train sounds will randomly play throughout the melodies. The bell light will flash with the sound.

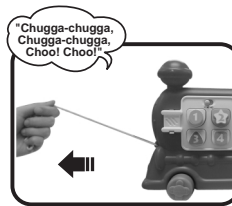

7. If there is no input to the unit after approximately 10 seconds, you will hear fun train sounds. After another 10 seconds if there is still no input, the unit will announce "all aboard!" If there continues to be no input to the unit, it will automatically power-down.



## MELODY LIST

1. B-I-N-G-O
2. Three Little Kittens
3. I've Been Working on the Railroad
4. Oh! Susanna
5. Here We Go Round the Mulberry Bush
6. Ring Around the Rosy
7. This Old Man
8. Teddy Bears' Picnic

## SUNG SONG LYRICS: (to the tune of Twinkle, Twinkle Little Star)

All aboard, it's time to go  
Can you hear the whistle blow?  
Now the train rolls down the track.  
As the wheels go clickety clack.  
All aboard, it's time to go  
Can you hear the whistle blow?

## CARE & MAINTENANCE

1. Keep the unit clean by wiping it with a slightly damp cloth.
2. Keep the unit out of direct sunlight and heat source.
3. Remove the batteries when the unit is not in use for an extended period of time.
4. Do not drop the unit on hard surfaces and do not expose the unit to moisture or water.

## TROUBLESHOOTING

If for some reason the program/activity stops working or malfunctions, please follow these steps:

1. Turn the unit **OFF**.
2. Interrupt the power supply by removing the batteries.
3. Let the unit stand for a few minutes, then replace the batteries.
4. Turn the unit **ON**. The unit should now be ready to play again.
5. If the product still does not work, replace with a new set of batteries.

If the problem persists, please call our Consumer Services Department at 1-800-521-2010 in the U.S. or 1-877-352-8697 in Canada, and a service representative will be happy to help you.

**IMPORTANT NOTE:**

Creating and developing **Infant Learning** products is accompanied by a responsibility that we at **VTech®** take very seriously. We make every effort to ensure the accuracy of the information, which forms the value of our products. However, errors sometimes can occur. It is important for you to know that we stand behind our products and encourage you to call our Consumer Services Department at 1-800-521-2010 in the U.S., or 1-877-352-8697 in Canada, with any problems and/or suggestions that you might have. A service representative will be happy to help you.

**Note:**

This equipment has been tested and found to comply with the limits for a Class B digital device, pursuant to Part 15 of the FCC Rules. These limits are designed to provide reasonable protection against harmful interference in a residential installation. This equipment generates, uses and can radiate radio frequency energy and, if not installed and used in accordance with the instructions, may cause harmful interference to radio communications. However, there is no guarantee that interference will not occur in a particular installation. If this equipment does cause harmful interference to radio or television reception, which can be determined by turning the equipment off and on, the user is encouraged to try to correct the interference by one or more of the following measures:

- Reorient or relocate the receiving antenna
- Increase the separation between the equipment and receiver
- Connect the equipment into an outlet on a circuit different from that to which the receiver is connected
- Consult the dealer or an experienced radio/TV technician for help

THIS DEVICE COMPLIES WITH PART 15 OF THE FCC RULES. OPERATION IS SUBJECT TO THE FOLLOWING TWO CONDITIONS: (1) THIS DEVICE MAY NOT CAUSE HARMFUL INTERFERENCE, AND (2) THIS DEVICE MUST ACCEPT ANY INTERFERENCE RECEIVED, INCLUDING INTERFERENCE THAT MAY CAUSE UNDESIRE OPERATION.

THIS CLASS B DIGITAL APPARATUS COMPLIES WITH CANADIAN ICES-003.

CET APPAREIL NUMÉRIQUE DE LA CLASSE B EST CONFORME À LA NORME NMB-003 DU CANADA.